

RECEIVED

03 JUN 2010

RECEIVED

03 JUN 2010

Application to vary a premises licence under the Licensing Act 2003

PLEASE READ THE FOLLOWING INSTRUCTIONS FIRST

Before completing this form please read the guidance notes at the end of the form. If you are completing this form by hand please write legibly in block capitals. In all cases ensure that your answers are inside the boxes and written in black ink. Use additional sheets if necessary. You may wish to keep a copy of the completed form for your records.

I/We Seven Eleven Foods Ltd
 (Insert name(s) of applicant)

being the premises licence holder, apply to vary a premises licence under section 34 of the Licensing Act 2003 for the premises described in Part 1 below

Premises licence number 828825
--

Part 1 – Premises Details

Postal address of premises or, if none, ordnance survey map reference or description Londis 93 Lordship Lane London SE22 8HU			
Post town	London	Post code	SE22 8HU

Telephone number at premises (if any)	0208 2991344
Non-domestic rateable value of premises	£10000

Part 2 – Applicant details

Daytime contact telephone number	0207 6227711		
E-mail address (optional)			
Current postal address if different from premises address	192-194 Clapham High Street London SW4 7UD		
Post Town	London	Postcode	SW4 7UD

Part 3 - Variation

Please tick yes

Do you want the proposed variation to have effect as soon as possible?

If not do you want the variation to take effect from

Day Month Year

--	--	--	--	--	--	--	--	--	--

Please describe briefly the nature of the proposed variation (Please see guidance note 1)

The proposed variation is to allow the store to retail alcohol for 24 hours a day 7 days per week. Also to allow the store to offer late night refreshment from 2300 hours until 0500 hours Monday to Sunday inclusive.

The store also wishes to add a promotional gondola end to the space allocated for the sale of alcohol. (see plans)

The store trades as a convenience store to be part of the Londis symbol group, retailing a full range of convenience product, including the sale of alcohol for consumption off the premises.

If your proposed variation would mean that 5,000 or more people are expected to attend the premises at any one time, please state the number expected to attend

Part 4 Operating Schedule

Please complete those parts of the Operating Schedule below which would be subject to change if this application to vary is successful.

Provision of regulated entertainment

Please tick yes

- a) plays (if ticking yes, fill in box A)
- b) films (if ticking yes, fill in box B)
- c) indoor sporting events (if ticking yes, fill in box C)
- d) boxing or wrestling entertainment (if ticking yes, fill in box D)
- e) live music (if ticking yes, fill in box E)
- f) recorded music (if ticking yes, fill in box F)
- g) performances of dance (if ticking yes, fill in box G)
- h) anything of a similar description to that falling within (e), (f) or (g) (if ticking yes, fill in box H)

Provision of entertainment facilities:

- i) making music (if ticking yes, fill in box I)
- j) dancing (if ticking yes, fill in box J)
- k) entertainment of a similar description to that falling within (i) or (j) (if ticking yes, fill in box K)

Provision of late night refreshment (if ticking yes, fill in box L)

Sale by retail of alcohol (if ticking yes, fill in box M)

In all cases complete boxes N, O and P

A

Plays Standard days and timings (please read guidance note 6)			Will the performance of a play take place indoors or outdoors or both – please tick (please read guidance note 2)	Indoors	<input type="checkbox"/>
				Outdoors	<input type="checkbox"/>
				Both	<input type="checkbox"/>
Day	Start	Finish	Please give further details here (please read guidance note 3)		
Mon					
Tue					
Wed			State any seasonal variations for performing plays (please read guidance note 4)		
Thur					
Fri					
Sat			Non standard timings. Where you intend to use the premises for the performance of plays at different times to those listed in the column on the left, please list (please read guidance note 5)		
Sun					

B

Films Standard days and timings (please read guidance note 6)			Will the exhibition of films take place indoors or outdoors or both – please tick (please read guidance note 2)	Indoors	<input type="checkbox"/>
				Outdoors	<input type="checkbox"/>
				Both	<input type="checkbox"/>
Day	Start	Finish	Please give further details here (please read guidance note 3)		
Mon					
Tue					
Wed			State any seasonal variations for the exhibition of films (please read guidance note 4)		
Thur					
Fri			Non standard timings. Where you intend to use the premises for the exhibition of films at different times to those listed in the column on the left, please list (please read guidance note 5)		
Sat					
Sun					

C

Indoor sporting events Standard days and timings (please read guidance note 6)			<u>Please give further details</u> (please read guidance note 3)
Day	Start	Finish	
Mon			
Tue			<u>State any seasonal variations for indoor sporting events</u> (please read guidance note 4)
Wed			
Thur			<u>Non standard timings. Where you intend to use the premises for indoor sporting events at different times to those listed in the column on the left, please list</u> (please read guidance note 5)
Fri			
Sat			
Sun			

D

Boxing or wrestling entertainments Standard days and timings (please read guidance note 6)			<u>Will the boxing or wrestling entertainment take place indoors or outdoors or both – please tick</u> (please read guidance note 2)	Indoors	<input type="checkbox"/>			
				Outdoors	<input type="checkbox"/>			
Both	<input type="checkbox"/>							
Day	Start	Finish	<u>Please give further details here</u> (please read guidance note 3)					
Mon								
Tue								
Wed						<u>State any seasonal variations for boxing or wrestling entertainment</u> (please read guidance note 4)		
Thur								
Fri						<u>Non standard timings. Where you intend to use the premises for boxing or wrestling entertainment at different times to those listed in the column on the left, please list</u> (please read guidance note 5)		
Sat								
Sun								

E

Live music Standard days and timings (please read guidance note 6)			Will the performance of live music take place indoors or outdoors or both – please tick (please read guidance note 2)	Indoors	<input type="checkbox"/>
				Outdoors	<input type="checkbox"/>
				Both	<input type="checkbox"/>
Day	Start	Finish			
Mon			Please give further details here (please read guidance note 3)		
Tue					
Wed			State any seasonal variations for the performance of live music (please read guidance note 4)		
Thur					
Fri			Non standard timings. Where you intend to use the premises for the performance of live music at different times to those listed in the column on the left, please list (please read guidance note 5)		
Sat					
Sun					

F

Recorded music Standard days and timings (please read guidance note 6)			<u>Will the playing of recorded music take place indoors or outdoors or both – please tick</u> (please read guidance note 2)	Indoors	<input type="checkbox"/>
				Outdoors	<input type="checkbox"/>
				Both	<input type="checkbox"/>
Day	Start	Finish	<u>Please give further details here</u> (please read guidance note 3)		
Mon					
Tue			<u>State any seasonal variations for the playing of recorded music</u> (please read guidance note 4)		
Wed					
Thur			<u>Non standard timings. Where you intend to use the premises for the playing of recorded music at different times to those listed in the column on the left, please list</u> (please read guidance note 5)		
Fri					
Sat					
Sun					

G

Performances of dance Standard days and timings (please read guidance note 6)			Will the performance of dance take place indoors or outdoors or both – please tick (please read guidance note 2)	Indoors	<input type="checkbox"/>			
				Outdoors	<input type="checkbox"/>			
				Both	<input type="checkbox"/>			
Day	Start	Finish	Please give further details here (please read guidance note 3)					
Mon								
Tue								
Wed						State any seasonal variations for the performance of dance (please read guidance note 4)		
Thur								
Fri						Non standard timings. Where you intend to use the premises for the performance of dance at different times to those listed in the column on the left, please list (please read guidance note 5)		
Sat								
Sun								

H

<p>Anything of a similar description to that falling within (e), (f) or (g) Standard days and timings (please read guidance note 6)</p>			<p><u>Please give a description of the type of entertainment you will be providing</u></p>		
Day	Start	Finish	<p><u>Will this entertainment take place indoors or outdoors or both – please tick</u> (please read guidance note 2)</p>	Indoors	<input type="checkbox"/>
Mon				Outdoors	<input type="checkbox"/>
				Both	<input type="checkbox"/>
Tue			<p><u>Please give further details here</u> (please read guidance note 3)</p>		
Wed					
Thur			<p><u>State any seasonal variations for entertainment of a similar description to that falling within (e), (f) or (g)</u> (please read guidance note 4)</p>		
Fri					
Sat			<p><u>Non standard timings. Where you intend to use the premises for the entertainment of a similar description to that falling within (e), (f) or (g) at different times to those listed in the column on the left, please list</u> (please read guidance note 5)</p>		
Sun					

Provision of facilities for making music Standard days and timings (please read guidance note 6)			<u>Please give a description of the facilities for making music you will be providing</u>			
			<u>Will the facilities for making music be indoors or outdoors or both – please tick</u> (please read guidance note 2)			Indoors
			Outdoors			<input type="checkbox"/>
			Both			<input type="checkbox"/>
Day	Start	Finish	<u>Please give further details here</u> (please read guidance note 3)			
Mon						
Tue			<u>State any seasonal variations for the provision of facilities for making music</u> (please read guidance note 4)			
Wed						
Thur			<u>Non standard timings. Where you intend to use the premises for provision of facilities for making music at different times to those listed in the column on the left, please list</u> (please read guidance note 5)			
Fri						
Sat						
Sun						

J

Provision of facilities for dancing Standard days and timings (please read guidance note 6)			Will the facilities for dancing be indoors or outdoors or both – please tick (see guidance note 2)	Indoors <input type="checkbox"/>	
				Outdoors <input type="checkbox"/>	
				Both <input type="checkbox"/>	
			Please give a description of the facilities for dancing you will be providing		
Day	Start	Finish			
Mon			Please give further details here (please read guidance note 3)		
Tue					
Wed			State any seasonal variations for providing dancing facilities (please read guidance note 4)		
Thur					
Fri			Non standard timings. Where you intend to use the premises for the provision of facilities for dancing at different times to those listed in the column on the left, please list (please read guidance note 5)		
Sat					
Sun					

K

Provision of facilities for entertainment of a similar description to that falling within i or j Standard days and timings (please read guidance note 6)			<u>Please give a description of the type of entertainment facility you will be providing</u>		
Day	Start	Finish	<u>Will the entertainment facility be indoors or outdoors or both – please tick</u> (please read guidance note 2)	Indoors	<input type="checkbox"/>
Mon				Outdoors	<input type="checkbox"/>
				Both	<input type="checkbox"/>
Tue			<u>Please give further details here</u> (please read guidance note 3)		
Wed					
Thur			<u>State any seasonal variations for the provision of facilities for entertainment of a similar description to that falling within i or j</u> (please read guidance note 4)		
Fri					
Sat			<u>Non standard timings. Where you intend to use the premises for the provision of facilities for entertainment of a similar description to that falling within i or j at different times to those listed in the column on the left, please list</u> (please read guidance note 5)		
Sun					

L

Late night refreshment Standard days and timings (please read guidance note 6)			Will the provision of late night refreshment take place indoors or outdoors or both – please tick (please read guidance note 2)	Indoors	<input type="checkbox"/>
				Outdoors	<input type="checkbox"/>
				Both	<input type="checkbox"/>
Day	Start	Finish			
Mon			Please give further details here (please read guidance note 3)		
Tue					
Wed			State any seasonal variations for the provision of late night refreshment (please read guidance note 4)		
Thur					
Fri			Non standard timings. Where you intend to use the premises for the provision of late night refreshment at different times, to those listed in the column on the left, please list (please read guidance note 5)		
Sat					
Sun					

M

Supply of alcohol Standard days and timings (please read guidance note 6)			Will the supply of alcohol be for consumption (Please tick box) (please read guidance note 7)	On the premises	<input type="checkbox"/>
				Off the premises	<input checked="" type="checkbox"/>
				Both	<input type="checkbox"/>
Day	Start	Finish	<u>State any seasonal variations for the supply of alcohol</u> (please read guidance note 4) Same hours to apply for every day of the year		
Mon	24	hours			
Tue	24	hours			
Wed	24	hours			
Thur	24	hours			
Fri	24	hours			
Sat	24	hours			
Sun	24	hours			
			<u>Non-standard timings. Where you intend to use the premises for the supply of alcohol at different times to those listed in the column on the left, please list</u> (please read guidance note 5)		

N

Please highlight any adult entertainment or services, activities, other entertainment or matters ancillary to the use of the premises that may give rise to concern in respect of children (please read guidance note 8)

None

O

Hours premises are open to the public Standard days and timings (please read guidance note 6)			State any seasonal variations (please read guidance note 4)	
Day	Start	Finish		
Mon	0000	0000		
	24	hour		
Tue	0000	0000		
	24	hour		
Wed	0000	0000		
	24	hour		
Thur	0000	0000		Non standard timings. Where you intend the premises to be open to the public at different times from those listed in the column on the left, please list (please read guidance note 5)
	24	hour		
Fri	0000	0000		
	24	hour		
Sat	0000	0000		
	24	hour		
Sun	0000	0000		
	24	hour		

Please identify those conditions currently imposed on the licence which you believe could be removed as a consequence of the proposed variation you are seeking

None

Please tick yes

- I have enclosed the premises licence
- I have enclosed the relevant part of the premises licence

If you have not ticked one of these boxes please fill in reasons for not including the licence, or part of it, below

Reasons why I have failed to enclose the premises licence or relevant part of premises licence

P Describe any additional steps you intend to take to promote the four licensing objectives as a result of the proposed variation:

a) General – all four licensing objectives (b,c,d,e) (please read guidance note 9)

The store currently has a licence and operates to a high standard with regard to the sale of alcohol, and will continue to do so for all the stated hours should this licence be granted. The store is looking to increase the hours of trade for alcohol and all procedures will apply during the increased hours. All staff will be fully trained in their responsibilities with regard to the sale of alcohol, and will be retrained every six months.

b) The prevention of crime and disorder

An extensive CCTV system will be in operation to provide security and identify any culprit who is intent in causing trouble in store. There is a monitor on the shop floor as well as a monitor on the Managers office. All images are stored on the hard drive for a period of 30 days after which they can be erased or saved to disc at the request of the police. All current security measures will remain in operation. All staff have been fully trained in this area. Images will be made available to the police or authorised licensing officer from the council on request.

c) Public safety

Staff will be trained to be alert to any potential danger to customers and react accordingly. If they are unable to quickly diffuse the situation without risk to customer or staff, then they are instructed to call the police. All relevant fire procedures are in place for a store of this size.

d) The prevention of public nuisance

Youths will be encouraged to move from the entrance to the store to prevent the potential of causing nuisance to customers, either in requesting they purchase alcohol on their behalf, or general intimidating behaviour. The entrance to the store is also visible from the till point area, and so can be monitored by the staff. CCTV cameras will also pick up any disturbance in this area.

e) The protection of children from harm

Only photographic ID will be accepted (passport, driving licence, citizen card with hologram). Anyone who appears to be under the age of 21 will be challenged to provide ID. If the customer is unable to provide identification then no sale is made. No ID no sale. Any staff member who may be under the age of 18 must call a senior staff member to take over the sale and complete the transaction. If it is known that a customer intends to purchase alcohol to provide to minors then that sale will be refused. A refusals book will be set up and used to record all sales that are refused due to purchases being attempted by the under age. This book will be kept up to date at all times and made available to the Police and Licensing Authority on request.

Please tick yes

- I have made or enclosed payment of the fee
- I have sent copies of this application and the plan to responsible authorities and others where applicable
- I understand that I must now advertise my application
- I have enclosed the premises licence or relevant part of it or explanation
- I understand that if I do not comply with the above requirements my application will be rejected

IT IS AN OFFENCE, LIABLE ON CONVICTION TO A FINE UP TO LEVEL 5 ON THE STANDARD SCALE, UNDER SECTION 158 OF THE LICENSING ACT 2003 TO MAKE A FALSE STATEMENT IN OR IN CONNECTION WITH THIS APPLICATION

Part 5 – Signatures (please read guidance note 10)

Signature of applicant (the current premises licence holder) or applicant's solicitor or other duly authorised agent (please read guidance note 11). **If signing on behalf of the applicant please state in what capacity.**

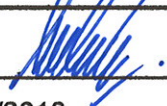
Signature	
Date	02/06/2010
Capacity	Licensing Agent as Appointed by the Applicant

Where the premises licence is jointly held signature of 2nd applicant (the current premises licence holder) or 2nd applicant's solicitor or other authorised agent (please read guidance note 12). **If signing on behalf of the applicant please state in what capacity.**

Signature	
Date	
Capacity	

Contact name (where not previously given) and address for correspondence associated with this application (please read guidance note 13)			
GP Retail Services Ltd Springfield House Springfield Road Grantham Lincolnshire NG31 7BG			
Post town	Grantham	Post code	NG31 7BG
Telephone number (if any)		01476 514691	
If you would prefer us to correspond with you by e-mail your e-mail address (optional) stewart.gibson@gpretail.co.uk			

Notes for Guidance

This application cannot be used to vary the licence so as to extend the period for which the licence has effect or to vary substantially the premises to which it relates. If you wish to make that type of change to the premises licence you should make a new premises licence application under section 17 of the Licensing Act 2003.

1. Describe the premises. For example the type of premises, its general situation and layout and any other information which could be relevant to the licensing objectives. Where your application includes off-supplies of alcohol and you intend to provide a place for consumption of these off-supplies you must include a description of where the place will be and its proximity to the premises.
2. Where taking place in a building or other structure please tick as appropriate. Indoors may include a tent.
3. For example state type of activity to be authorised, if not already stated, and give relevant further details, for example (but not exclusively) whether or not music will be amplified or unamplified.
4. For example (but not exclusively), where the activity will occur on additional days during the summer months.
5. For example (but not exclusively), where you wish the activity to go on longer on a particular day e.g. Christmas Eve.
6. Please give timings in 24 hour clock (e.g. 16:00) and only give details for the days of the week when you intend the premises to be used for the activity.
7. If you wish people to be able to consume alcohol on the premises please tick on, if you wish people to be able to purchase alcohol to consume away from the premises please tick off. If you wish people to be able to do both please tick both.
8. Please give information about anything intended to occur at the premises or ancillary to the use of the premises which may give rise to concern in respect of children regardless of whether you intend children to have access to the premises, for example (but not exclusively) nudity or semi-nudity, films for restricted age groups, the presence of gaming machines.
9. Please list here steps you will take to promote all four licensing objectives together.
10. The application form must be signed.
11. An applicant's agent (for example solicitor) may sign the form on their behalf provided that they have actual authority to do so.
12. Where there is more than one applicant, both applicants or their respective agents must sign the application form.
13. This is the address which we shall use to correspond with you about this application.

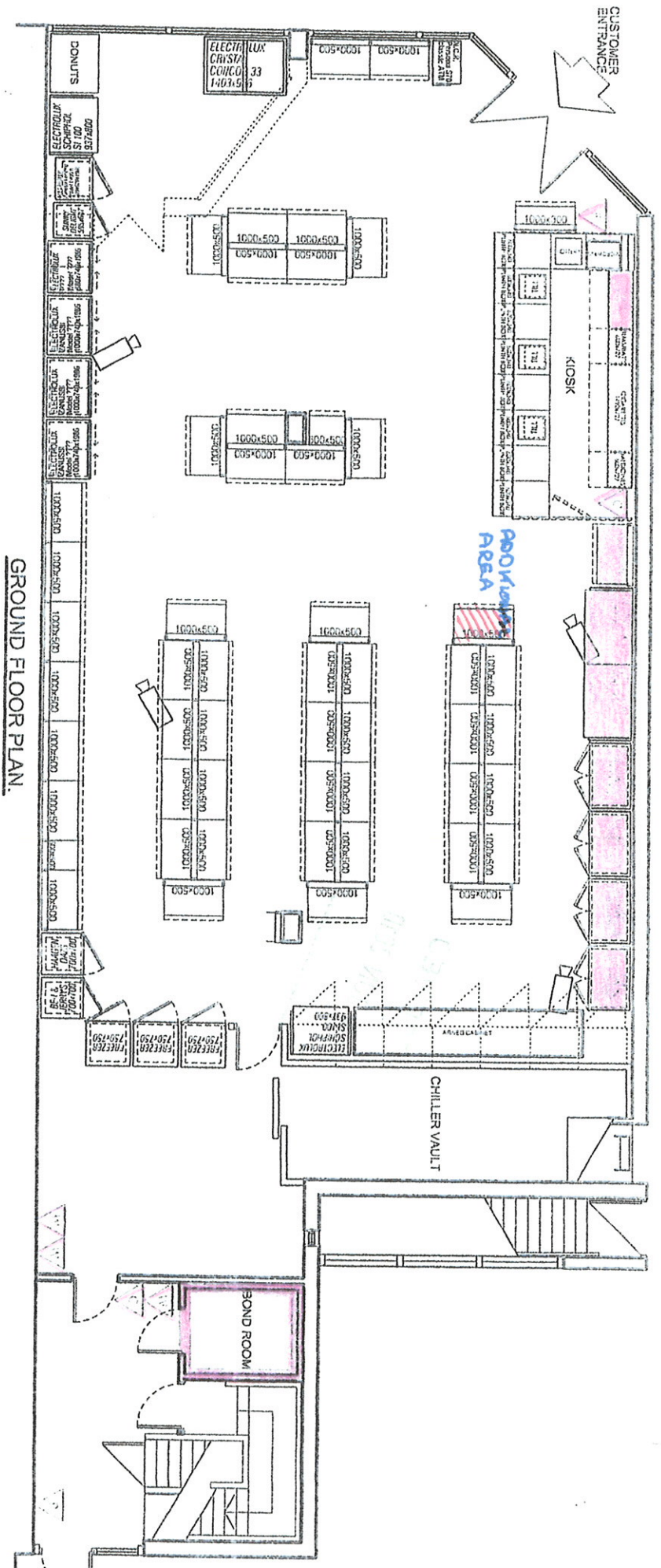

GROUND FLOOR PLAN.

FIRE SAFETY KEY

PRE SYMBOL	TO COMPLY WITH
	B.S. 5429:2000 PT 1
	B.S. 5429:2000 PT 1
	B.S. 5429:2000 PT 1
	B.S. 5429:2000 PT 1
	B.S. 5429:2000 PT 1
	B.S. 5429:2000 PT 1
	B.S. 5429:2000 PT 1
	B.S. 5429:2000 PT 1
	B.S. 5429:2000 PT 1
	B.S. 5429:2000 PT 1
	B.S. 5429:2000 PT 1
	B.S. 5429:2000 PT 1
	B.S. 5429:2000 PT 1
	B.S. 5429:2000 PT 1

LONDIS,
 93 LORDSHIP LANE
 LONDON
 SE 22 8NU.
 SCALE 1:100